

REVO

OPERATOR INSTRUCTIONS

LOCATION AND METHOD OF ADJUSTMENT

⑤ INDEPENDENT BACK ANGLE - *OPTIONAL*

① SEAT HEIGHT

② TILT TENSION

SEAT DEPTH ④
- *OPTIONAL*

TILT LOCK ③

① SEAT HEIGHT Adjustment

- Access handle (right side of chair)
- To RAISE Height – Lift body weight off seat & pull lever upward
- To LOWER Height – Pull lever upward when seated

② TILT TENSION Adjustment

- Pull out telescoping handle (right side of chair)
- To INCREASE Tension – Rotate handle forward (clockwise)
- To DECREASE Tension – Rotate handle rearward

③ TILT LOCK Adjustment

- Access handle (left side of chair)
- To ENGAGE Lock – Rotate handle forward (counter clockwise)
- To DISENGAGE Lock – Rotate handle rearward, lean back into the chair to release the tilt lock feature.

④ SEAT DEPTH Adjustment - *OPTIONAL*

- While seated, access handle (left side of chair)
- To RELEASE Lock – Pull and hold lever upward
- Slide seat forward or rearward to desired location
- To ENGAGE Lock – Release lever

⑤ INDEPENDENT BACK ANGLE Adjustment - *OPTIONAL*

- Access handle (right side of chair)
- To INCREASE Angle – Rotate handle forward (clockwise)
- To DECREASE Angle – Rotate handle rearward

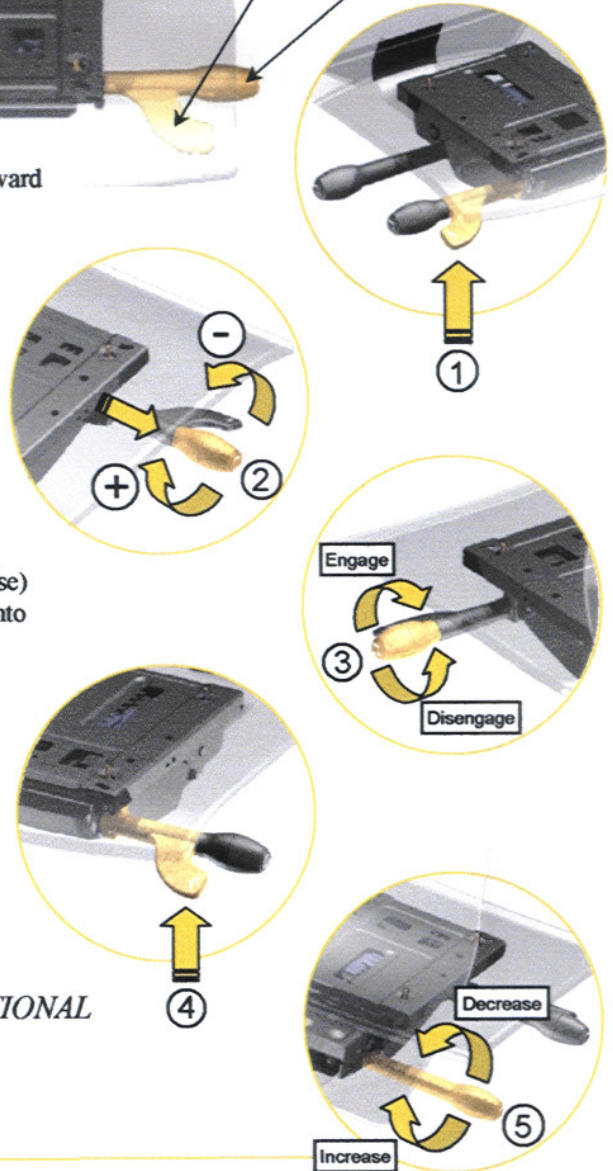

24-7
chair

Pro/File Systems, Inc.

135 S. Kalamath Street, Denver, Colorado 80223
(303) 825-8005, (800) 624-6254, Fax (303) 623-6472
www.profileoffice.com